

# FOAMULAR®

Energy-Saving, Moisture-Resistant XPS Insulation

Typical timber stud wall construction showing thermal resistance values (R value) of wall components.

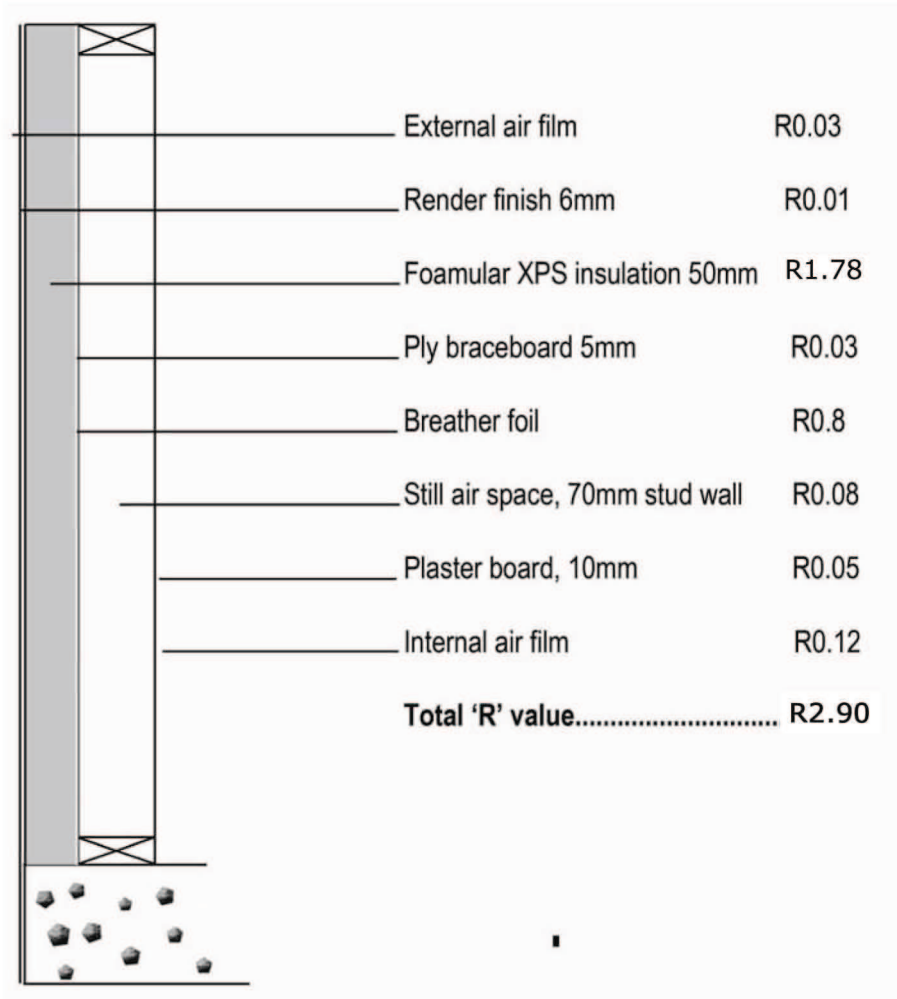

Optional inclusion of glasswool batts (R1.5) would increase total value to R4.40  
 Optional use of 75mm Foamular in lieu of 50mm would increase total value to R3.79  
 Foamular 75mm with glasswool wall batts (R1.5) would increase total value to R5.29